

Times



PROJECT SPOTLIGHT

Illumio, 920 Deguigne Dr., Sunnyvale

Recently named by Forbes as one of the Top 100 private cloud companies in the world, Illumio is a leader in micro-segmentation to reduce cyber risk and the spread of breaches inside massive data centers and cloud environments. Its many high-profile clients include giants like Morgan Stanley, BNP Paribas, Salesforce, and Oracle NetSuite. So it was no small honor to be chosen as a member of the construction team which recently completed a stunning tenant improvement for Illumio's new 2-story, 57,560 sq. ft. corporate center in Sunnyvale.

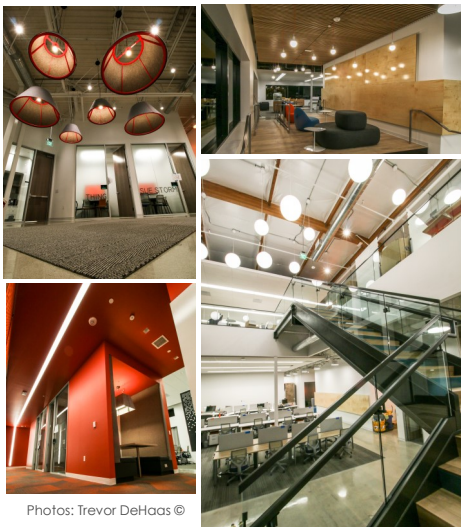

Working together with Bay Area Builders, NAE's team provided design, engineering and construction/installation of electrical, lighting, power systems and dual-head ChargePoint EV chargers. Project Manager Brian Spangle and Foreman Ronnie Aguiniga, with leads Jose Hernandez, Rudy Hernandez and Oscar Vallejo, led an outstanding team of electricians and trainees in completion of the fast-tracked project. Together with Dylan Brubaker, Josh Cabral, James Cain, Tomas Carnahan-Nazario, Matt Castillo, Nick Gonzales, Rene Karimian, Enrique Morales, Okitondo Munganga, Hector Ornelas, Jesse Padilla, Justin Sotelo and Don Stuhr, the team tracked over 12,800 man-hours in completion of the complex TI.

"The extensive lighting package with a revolutionary Lutron Vive wireless lighting control system required critical problem solving to sync the state-of-the-art wireless system with existing inverters," noted Brian. "It was a challenge but we finished on time, within budget, and with a satisfied client!"

Congratulations on yet another fantastic job by an awesome NAE team! 🙌

Photos: Trevor DeHaas ©

MEET YOUR NAE TEAM—THE HUGHEY/GONTERMAN BROTHERS



Codey Hughey

Q: How did you all get started in the electrical trade?

C – Nick's and my grandfather founded Custom Electric back the early days of 'Silicon Valley'. Unfortunately, he passed away too young, and our mom Diane took over; she was only 19 at the time and running a small commercial electrical company on her own. She kept it together for seven good years, but in 1986, at 26 and facing an unstable economy with two children to raise, she made the tough and sad decision to sell.



Nick Hughey

J – My dad is also an electrician/business owner, and he taught me early on the value of learning a skilled trade that can carry you through life. In 1992, when he met Codey and Nick's mom, who still had her C-10 license, it was a natural fit for our two blended families.



Jason Gonterman

N – Being around the electrical business since we were children, it just felt right for each of us to follow in the family trade.

Q: What brought you all to NAE?

C: While working for my stepdad at JG Electric, I was invited to play a round of golf with Tim Johnson at Royal Electric (now CED). Kurt was in that foursome. I connected again with Kurt in 2004. JG Electric was in a slow period and I stopped into the NAE office to see if they were hiring. There was Kurt,

sitting behind his desk. NAE was in a growth mode and Kurt asked me if I knew of others wanting to advance their careers. I immediately introduced him to Jason, and later in 2007 Nick joined us.

Q: Which projects are your personal favorites and why?

C: The Nike store at the Great Mall, it was a fun, upbeat space and great place to work.

J: TiVo. The two buildings have an interesting floor plan and smooth design finishes, along with a cafeteria and gym. We had a great team including Jim Harrison from South Bay Construction, and I had fun helping to design and install light zones and control systems.

N: The original Palo Alto Networks building in 2010, which paved the way to successful repeat business with PAN, on additional new TI's, and service/maintenance on three buildings/moves thereafter.

Q: What electrical skills are you known for?

J: Codey is an expert in on-site management. He's a start-to-finish 'new construction' specialist and always has the big picture in mind.

N: Jason has the best communication skills and easily maintains relationships with his crew, customers, superintendents, other trades, and office staff. Jason also has good design foresight.

C: Nick is a great detail guy, and the best installer and pipe runner.

Q: What advice do you have for those with less experience and wanting to grow?

C: In addition to completing your electrical training, sign up ...Cont'd

The Back Page

A MESSAGE FROM THE BOSS

Looking back over 2018, with its blessings and challenges, rewards and hurdles, it makes me proud to think about the great team we have here at NAE. Every day, I get to work with some of the best construction professionals in the Bay Area - from field and project management to accounting, office management and parts/delivery/warehouse staff! We work hard, but have a good time occasionally, and even manage a few laughs along the way. The work is challenging, interesting, fast-paced, skilled, technical, and requires critical thinking, and I'm grateful for the reputation we've achieved as one of Silicon Valley's top commercial electrical contractors.

I want to take this time to especially congratulate and thank the 2018 NAE employee award winners, as nominated by their peers, for the great work you have contributed this past year. Here's a huge round of applause to you!

★Chris Shackleton/Apprentice of the Year★

★Mark Yates/Electrician of the Year★

★Damir Svetic/Foreman of the Year★

★Chloe Brubaker/Office Person of the Year★

★Bryce Rocklage/Employee of the Year★



We are moving ahead in 2019 with great expectations. As a group, we need to work smarter and focus on winning projects while keeping costs down. We need to emphasize SAFETY as a top priority so we all can return to our homes at night, while continuing to promote our skills and expertise in an ever-changing and unpredictable market. That responsibility falls on all of us. It's up to each one of us to put our best foot forward every day, do our best work as safely and efficiently as possible, take initiative, be accountable and have not just our own, but also the company's best interests at heart. We need to nurture every relationship in order to continue growing and producing quality work - work being done by an awesome NAE team! 🐾

SAFETY CORNER

Flu Season Ahead — Excerpted from <http://www.cdc.gov/flu>

The CDC estimates that over 49 million people in the U.S. contracted the flu last year; they recommend a three-step approach to fighting back. The most important step is to get a flu vaccine each year. But if you get the flu, there are prescription antiviral drugs that can treat your illness. In addition, following these daily preventive actions may slow the spread of germs that cause flu.

- Try to avoid close contact with sick people.
- If you get sick, CDC recommends that you stay home for at least 24 hours after the fever is gone except to get medical care or for other necessities. The fever should be gone without the use of a fever-reducing medicine.
- While sick, limit contact with others as much as possible to keep from infecting them.
- Cover your nose and mouth with a tissue when you cough or sneeze. Throw the tissue in the trash after you use it.
- Wash your hands often with soap and water. If soap and water are not available, use an alcohol-based hand rub.
- Clean and disinfect surfaces and objects that may be contaminated with germs like the flu.

Following these everyday preventive actions will help slow the spread of germs that can cause many different illnesses while offering protection against the flu. 🐾

MARK YOUR CALENDARS:

Foremen's Meeting: First Monday Every Month at 6AM

(unless otherwise noted)

WHO KNEW

"I was training to be an electrician. I suppose I got wired the wrong way round somewhere along the line."

~Elvis Presley~



In Memory of
Buddy Hughey
2009~2018
One of the Original
NAE Office Pups

Hughey/Gonterman......for other college courses, or even go for your AA. The best electrician is an educated one!

J: If you really want a successful career, show up and be ready for what comes your way. NAE gives individuals many opportunities to further their careers; be prepared when the time comes. Work hard, listen to your foreman, and take on as much responsibility you can. Maintain a good work ethic and I promise you will get recognized.

N: Strap on your tool bag, put in a full days' work and then step back to see what you've completed - professionally, it's one of the best feelings of accomplishment I know of. Work hard and be proud of the work you do, it's important and helps make the world a better place.

Q: Describe your home life and things you enjoy doing in your spare time.

C: I thoroughly enjoy being an uncle! In my spare time, I like to mountain bike, take and edit photos and drone footage, and race RC cars. Someday I hope to visit Papua New Guinea.

Editor's note: Our condolences to Codey who recently lost his 4-legged best friend. "Buddy" spent many of his earlier years at the NAE office. He was a happy, sweet dog, we will all miss him.

J: My wife Jennifer and I live in Santa Cruz with our dog Cali, and we share custody of my daughter Jaelyn. We play recreational softball, go wake boarding, and work out at the gym. Each winter my brothers and our families hit the slopes snowboarding in Tahoe. And in January, we're all headed to Kauai to celebrate Nick's 'BIG 4-0' birthday!

N: My wife Gail and I have two kids, Samantha and Brandon, and we value spending as much of our spare time as possible with them and our dog Harvey. Extended family time is important as well, and our three families all spend many holidays and vacations together. I also like playing billiards, biking, camping, watching movies, and I'm currently updating and automating our new home.

Q: Brothers can be competitive. What's the most competitive thing you all do together?

C: Golf!

J: Golf!

N: It's always a great day when I beat my brothers' golf scores! 🐾

NEC TEST PREP QUESTIONS:

1. Circuit breakers are NOT listed for continuous-use, unless they have an ampere rating of at LEAST ____ or more.
A) 60 amperes C) 200 amperes
B) 100 amperes D) 600 amperes
2. In general, cablebus shall be securely supported at intervals NOT exceeding ____.
A) 10 feet C) 15 feet
B) 8 feet D) 12 feet
3. Grounding conductors and bonding jumpers shall NOT be connected by ____.
A) Exothermic welding C) Machine screw-type fasteners
B) Pressure connectors D) Sheet metal screws

Answers to Test Prep Questions: 1. d, 2. d, 3. d